

# Isolamin panel 33CL80

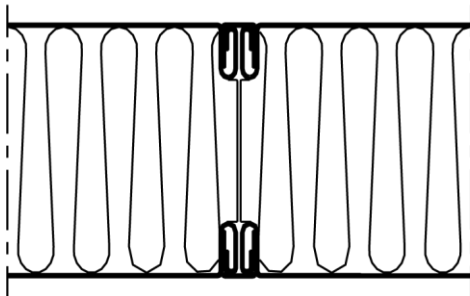
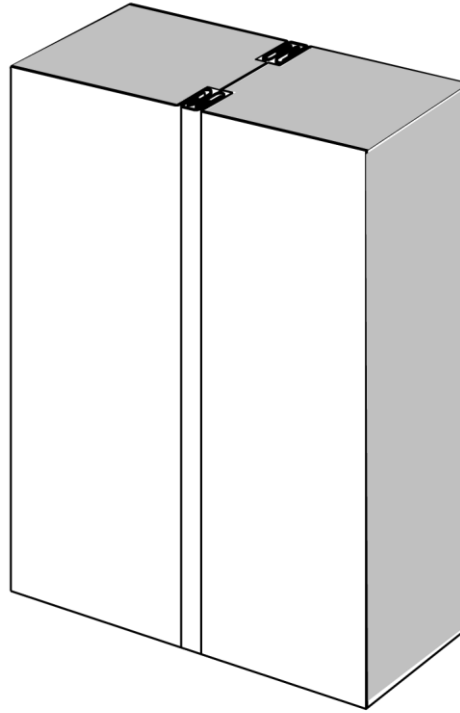

PANEL	33CL80
Thickness	80 mm
Weight	~26,1 kg/m <sup>2</sup>
Modulus width	565, 1180 mm
Reaction to fire	A2:s1:d0
Fire class	EI 60
Sound reduction	33dB Rw
U-value	0,58 W/m <sup>2</sup> K

TOLERANCES	CORE MATERIAL	SURFACE MATERIAL
Length: ± 5 mm Width: ± 1 mm Thickness: +0/-1 mm Rectangularity: 1 mm/m Curved surface: + 0/-0.35 mm	Material: Mineral wool Density: 180 kg/m <sup>3</sup> ±10%	Material: Hot dipped galvanised steel sheet Thickness: Galv, PVC, Painted 0,7 mm

The technical information in this edition was accurate at the time of the printing. We reserve the right to make changes due to the progressive development of our products. The latest information can be obtained upon request.